

Seals

Consultants

THIS DRAWING AND DESIGN MAY NOT BE USED ON OTHER PROJECTS WITHOUT WRITTEN PERMISSION FROM GENIVAR

- NOTES:
1. CONTRACTOR TO LOCATE AND PROTECT ALL EXISTING UNDERGROUND AND SURFACE UTILITIES.
 2. ALL WATERMANS, SEWER MAINS AND SERVICE CONNECTIONS SHALL BE INSTALLED ON CLASS 'B' BEDDING WITH CLASS II BACKFILL.
 3. ALL MATERIALS AND INSTALLATION SHALL BE IN ACCORDANCE WITH THE CITY OF SASKATOON STANDARD CONSTRUCTION SPECIFICATIONS, 2010 EDITION.

LEGEND

- EXISTING WATERMAIN
- EXISTING SANITARY SEWER
- EXISTING STORM SEWER
- PROPOSED WATER SERVICE - P.E. SDR 9
- PROPOSED STORM SEWER - PVC, SDR35
- PROPOSED SANITARY SEWER SERVICE - PVC, SDR26
- PROPOSED CB
- EXISTING CB
- CURB STOP
- FIRE HYDRANT & VALVE

On-site benchmark: Top of survey monument at South East corner of site, elevation: 497.395

Power Line Anchor

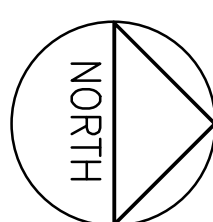

SITE PLAN

1 : 200

PROPOSED ALL TURNS

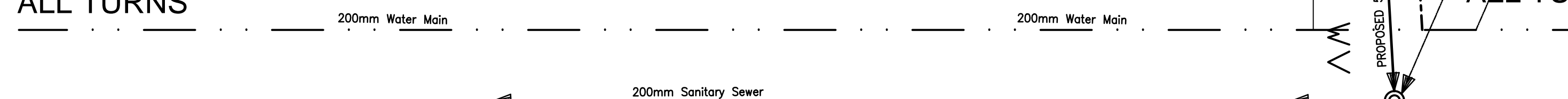

FAITHFULL AVENUE

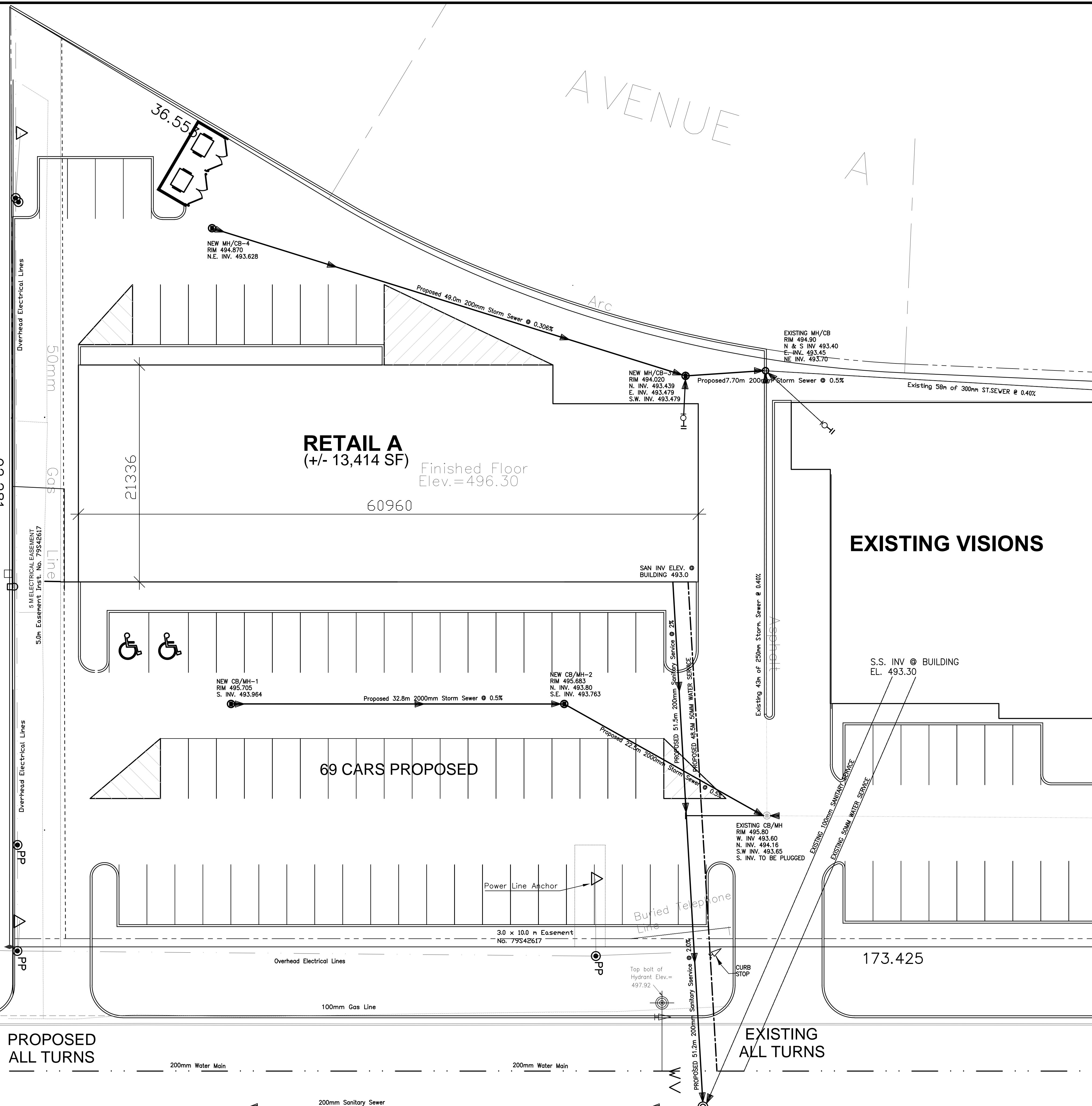

ISS.	REV.	DATE	APP.	DESCRIPTION
A		08/12/10		ISSUED FOR BUILDING PERMIT

Project
VISIONS REALITY PARKING LOT
SASKATOON SASKATCHEWAN

CIVIL

Drawing Title
SITE SERVICING PLAN

DESIGNED	FOS	APPROVED	
DRAWN	FOS	SCALE	1:200
CHECKED	RJW	DATE	08/08/2010
PROJECT NO.	DRAWING NO.	REV	
101-14796-00	C-100	A	