

| KEY | BOTANICAL NAME                         | COMMON NAME            | QTY. | SIZE        | SPACING     | REMARKS |
|-----|--|------------------------|------|-------------|-------------|---------|
|     | MAGNOLIA GALAXY                        | GALAXY MAGNOLIA        | 12   | 3.00 METERS | AS SHOWN    | B. & B. |
|     | CERCIDIPHYLLUM JAPONICUM               | KATSURA TREE           | 10   | 6 CM. CAL.  | AS SHOWN    | B. & B. |
|     | THUJA PLICATA                          | WESTERN RED CEDAR      | 3    | 2.50 METERS | AS SHOWN    | B. & B. |
|     | AZALEA JAPONICA 'LOUISE GABLE'         | PINK AZALEA            | 20   | #2 POT      | 85 CM. O.C. |         |
|     | AZALEA JAPONICA 'HINO CRIMSON'         | CRIMSON AZALEA         | 20   | #2 POT      | 85 CM. O.C. |         |
|     | ABELIA 'EDWARD GOUCHER'                | EDWARD GOUCHER ABELIA  | 20   | #3 POT      | 90 CM. O.C. |         |
|     | PINUS MUGO 'PUMILIO'                   | DWARF MUGO PINE        | 31   | #3 POT      | 90 CM. O.C. |         |
|     | RHODODENDRON YAKUSHIMANUM 'CRETE'      | YAK. RHODODENDRON      | 26   | #3 POT      | 90 CM. O.C. |         |
|     | RHODODENDRON FINNISH 'ELVIIRA'         | FINNISH RHODODENDRON   | 20   | #3 POT      | 90 CM. O.C. |         |
|     | SPIRAEA x BUMALDA 'GOLD FLAME'         | GOLD FLAME SPIRAEA     | 75   | #3 POT      | 90 CM. O.C. |         |
|     | ROSA MEIDLAND 'PINK'                   | PINK MEIDLAND ROSE     | 47   | #3 POT      | 90 CM. O.C. |         |
|     | VIBURNUM TINUS DWARF                   | SPING BOUQUET VIBURNUM | 43   | #3 POT      | 90 CM. O.C. |         |
|     | VIBURNUM DAVIDII                       | VIBURNUM               | 57   | #3 POT      | 90 CM. O.C. |         |
|     | RHODODENDRON YAKUSHIMANUM 'TEDDY BEAR' | YAK. RHODODENDRON      | 30   | #3 POT      | 90 CM. O.C. |         |
|     | THUJA PLICATA 'EXCELSA'                | WESTERN RED CEDAR      | 20   | 1.80 METERS | 90 CM. O.C. |         |

**NOTES / GENERAL**

- PLANT SIZES IN THIS LIST ARE SPECIFIED ACCORDING TO B.C. LANDSCAPE STANDARD "LATEST EDITION". CONTAINER SIZES ARE SPECIFIED AS PER "CIVIL STANDARDS" BOTH PLANT SIZE AND CONTAINER SIZE ARE THE MINIMUM ACCEPTABLE SIZES. SEARCH AND REVIEW MAKE PLANT MATERIAL AVAILABLE FOR OPTIONAL REVIEW BY "LANDSCAPE ARCHITECT" AT SOURCE OF SUPPLY. AREA OF SEARCH TO INCLUDE LOWER MAINLAND AND FRASER VALLEY. SUBSTITUTIONS MUST OBTAIN WRITTEN APPROVAL FROM THE "LANDSCAPE ARCHITECT" PRIOR TO MAKING ANY SUBSTITUTIONS TO SPECIFIED MATERIAL. UNAPPROVED SUBSTITUTIONS WILL BE REJECTED. ALLOW A MINIMUM OF TWO WORKING DAYS PRIOR TO DELIVERY FOR REQUEST TO SUBSTITUTE. SUBSTITUTIONS ARE SUBJECT TO "B.C. LANDSCAPE STANDARD".  
ALL PLANT MATERIAL MUST BE PROVIDED FROM CERTIFIED "DISEASE FREE" NURSERY.  
ALL PLANT MATERIAL MUST CONFORM TO THE LATEST EDITION OF THE "B.C. LANDSCAPE STANDARD". PROVIDE CERTIFICATION UPON REQUEST.  
ALL LANDSCAPING AND LANDSCAPE MATERIALS TO CONFORM TO THE LATEST EDITION OF THE B.C. LANDSCAPE "LANDSCAPE STANDARDS".
- Min. growing medium depths over prepared subgrade shall be :  
Lawn areas 450 mm  
Grd. cover areas 450 mm  
Shrub areas 450 mm  
Tree pits 300 mm around root ball.
- Growing medium shall have physical and chemical properties as described in the Standards for Level 2 and Level 3 Areas, except for areas over structures where the medium shall conform to the requirements for Level 1 applications.  
Processing and mixing of growing medium components shall be done off-site using a mechanized screening process.  
Proposed growing medium shall be tested by a recognized laboratory. The contractor shall guarantee that the soil submitted for testing is a representative sample taken from the soil that will be used at the site.
- On-site or Imported soils shall satisfy the requirements of the Standards for growing medium. Soils shall be virtually free from subsoil, wood incl. woody plant parts, weed or reproductive parts of weeds, plant pathogenic organisms, toxic materials, stones over 30 mm and foreign objects.  
All planting beds shall receive min. 50 mm bark mulch.
- Plant species and varieties may not be substituted without the approval of the Landscape Architect.
- The contractor shall guarantee all materials and workmanship for a period of one (1) full year from the date of Final Acceptance, unless otherwise specified.  
All plant material not surviving, or in poor condition during the guarantee period shall be replaced by the contractor at no extra cost to the Owner.
- The contractor shall clear away from the site all rubbish as it accumulates, and shall, at the completion of the work, leave the work and the site thereof in a clean and presentable condition, free from all obstructions.

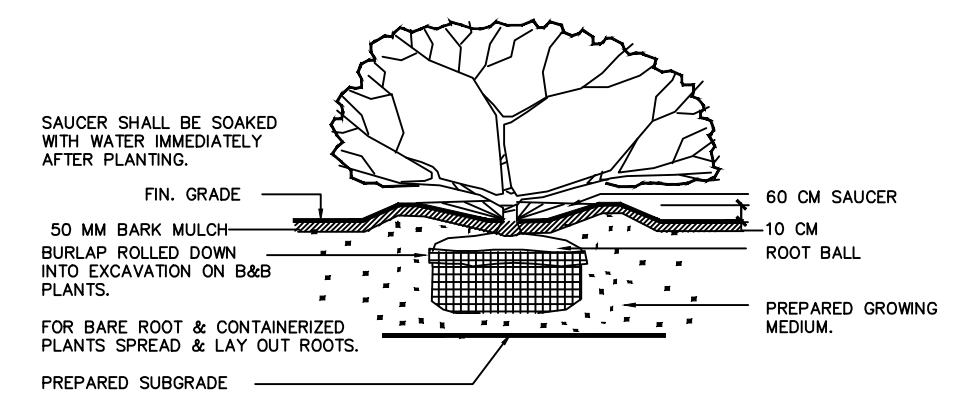

PLANTING DETAIL - SHRUBS & GRD. COVER PLANTS  
SECTION

N.T.S.

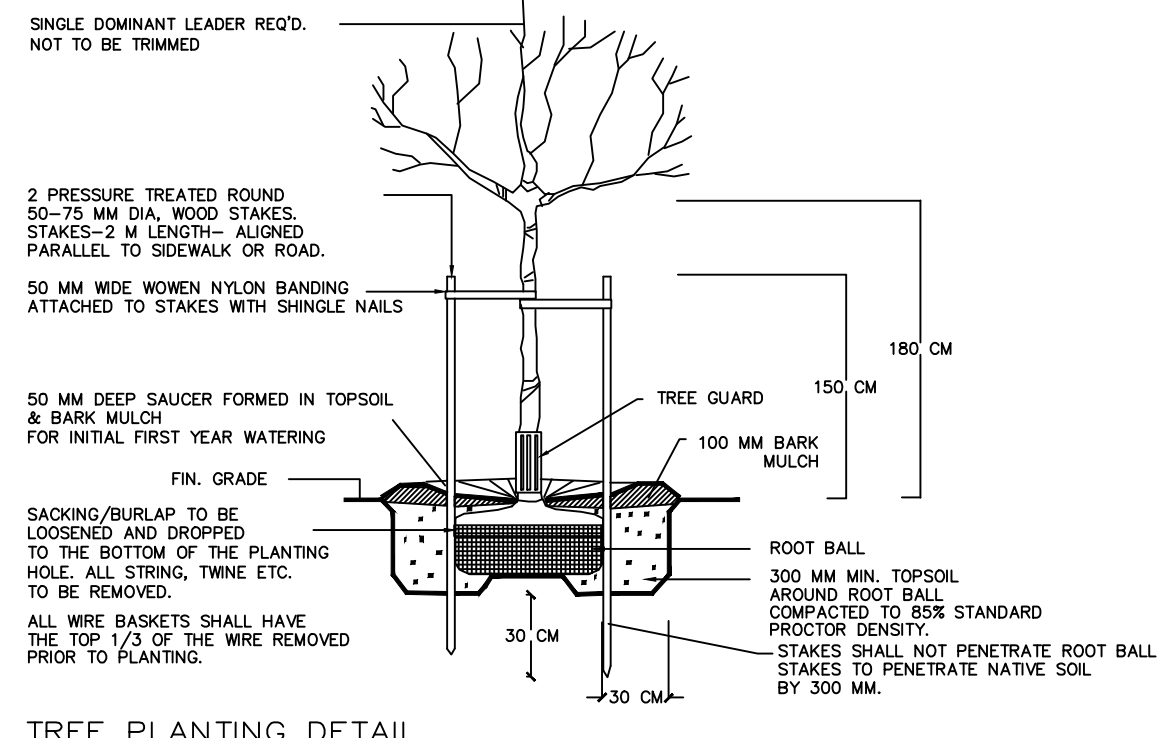

TREE PLANTING DETAIL  
SECTION

N.T.S.

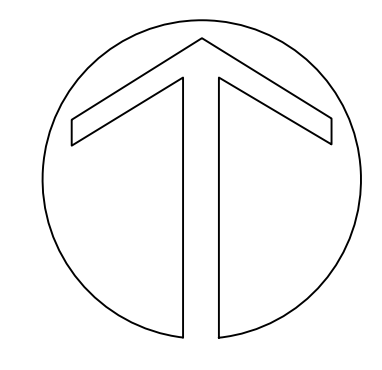

| DATE | REVISIONS | NO. |
|------|-----------|-----|
|      |           |     |

**C.KAVOLINAS & ASSOCIATES INC.**  
BCSLA CSLA  
  
21308 - 86 AVENUE,  
LANGLEY, B.C.  
V1M 1Z7  
  
PHONE (604) 888-2363

**CLIENT**  
  
ALIREZA TAVAKOLIAN  
P. J. LOVICK ARCHITECT LTD.  
3707 - 1st AVENUE  
BURNABY, B.C.  
V5C 3V6  
  
PHONE (604)

**TITLE**  
  
PLAN VIEW  
  
LANDSCAPE PLAN  
PROPOSED PHASE 2  
COMMERCIAL DEVELOPMENT  
20670 LANGLEY BYPASS  
CITY OF LANGLEY, B.C.

|             |             |
|-------------|-------------|
| SCALE 1:250 | DATE JAN/17 |
| DRAFT       | CHK'D       |
| ENG.        | CHK'D       |
| APPR'D      | AS BUILT    |

|         |             |
|---------|-------------|
| PRINTED | JOB No.     |
|         | DRAWING No. |
|         | L-1         |